

#whsterilization



video.wh.com

Now at  
your dealer  
or **wh.com**



# Convincing reasons for

the right water  
demineralizer system



multidem

# A new generation of **water demineralization**

Make the most of the many advantages offered by the installation of your new Multidem water demineralization system from W&H.

Multidem supplies top quality demineralized water for generating steam in sterilizers. As a result, it ensures consistent and optimized performance, thereby extending the service life of your sterilizer. In addition, the device is also equipped with a spray gun and is ideal for rinsing instruments prior to sterilization.



**3** unbeatable arguments for the perfect water treatment device:



# 1 Environmental friendly

Did you ever think about ...  
**the number of filters?**



## Thoughts about re-used water

- › Water can be used for several times, but do you really know how much water do you need to manufacture one filter?
- › How much waste do you produce compared to our solution and is there any biohazard re-filtering water? Is it a special waste?
- › How many times more do you have to clean the tanks, maybe with chemicals?
- › Does the water really meet the EN13060 standard?
- › Are you always aware of the water quality, free of any residual like oil, alcohol, protein residuals of bacteria which could cause fever?
- › And what about sterilization ...

The answer to all these questions: **Multidem**

### Completely economical

The water demineralizer system was designed to meet all environmentally requirements.

### Optimally reduced

Multidem filter cartridges reduce the overall mineral content of drinking water, thereby preventing deposits from forming in downstream terminal devices. Thanks to the flow method minerals with heavy ions such as lead and copper can be removed from the water.

### Fully recyclable

The packaging material of this product is suitable for recycling and can be reused.

# 2 Cost effective

Did you ever think about ...  
**your total costs?**



Other devices:	Multidem:
Not all cartridges fit different devices. Most of the time you need a separate cartridge for each sterilizer.	The water demineralizer device is suitable for use with many conventional sterilizers with spray gun. It is an all-in-one solution.
You need a filter to re-filter the water.	The device delivers consistently high water quality thus preventing lime scale deposits in the sterilizers.
More filters means more frequent maintenance. This also means more effort, numerous reorders and higher stock levels.	One filter means only one to replace. And this one is simple, too.
Different filters can mean different connections. Therefore, more installation costs.	The installation costs for the direct connection of the sterilizer to the tap water do not differ from our standard system.
€€€€€€€€€€	€€€

# Compatibility

thanks to the  
all-in-one solution

The water demineralization system is also suitable for use with many conventional sterilizers.

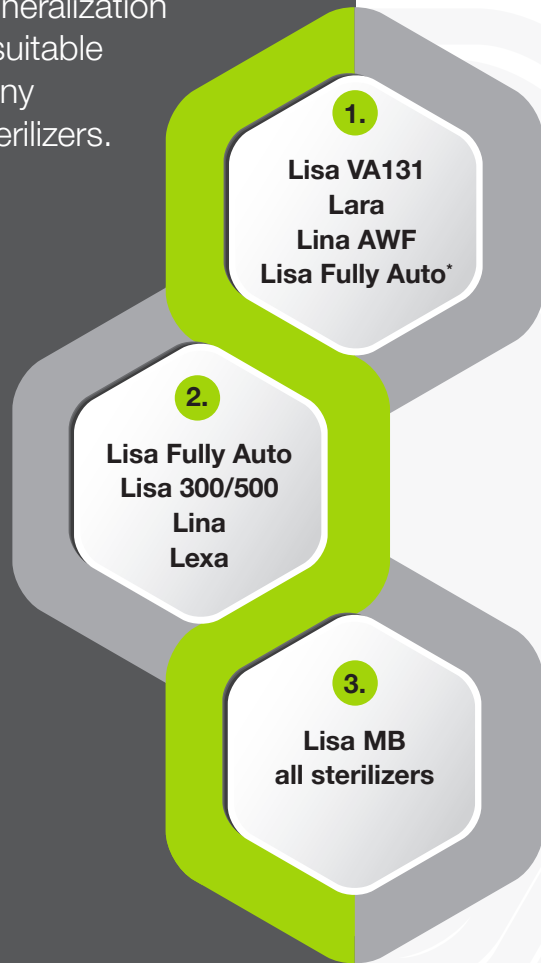

Thanks to the T-connection  
it is possible to:

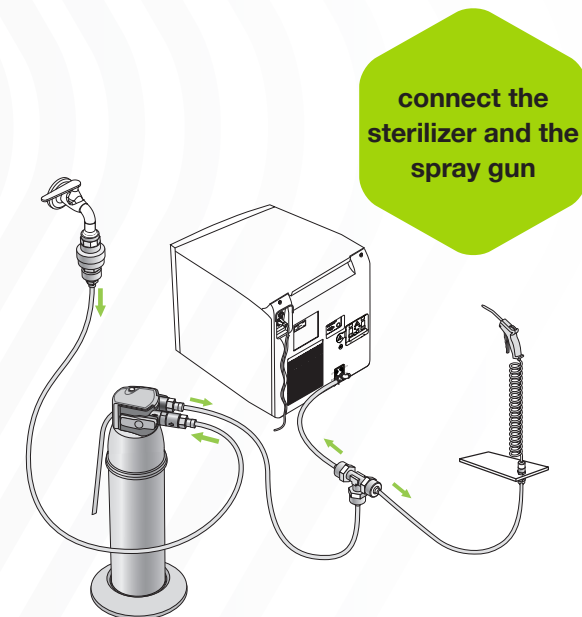
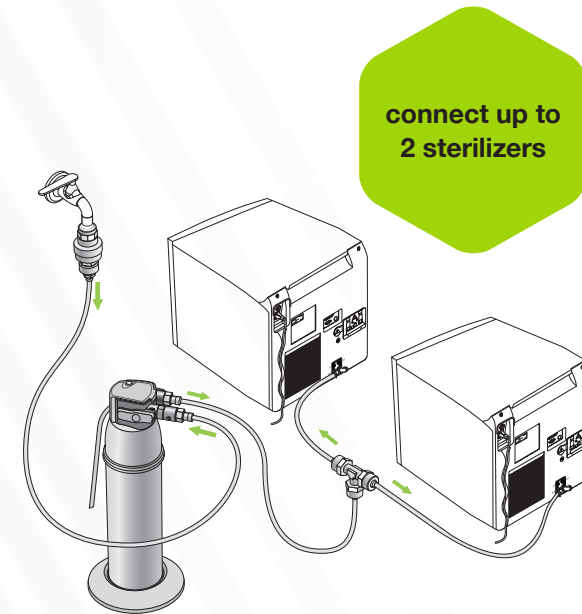

1. Multidem can be connected directly
2. Multidem can be connected via a connection system by using water supply connection kit (SAT/water supply kit)
3. The sterilizer can be filled manually with the aid of the spray gun

\* Applies to Lisa Fully Automatic devices manufactured from 04/2011

# 3 Easy to use

Did you ever think about ...  
**the usability?**

**Other devices often offer solutions with a resin filter inside the tank, that downgrades the hardness. For usability and ergonomics the requested maintenance is questionable, because:**

- › If you have to replace the filter, you have to open the tank and that means extra work and more effort.
- › More sterilizers you have, more filters you have to replace.
- › If the sterilizer is not connected to the tap water, you have to fill a jug with tap water before filling the sterilizer tank, this is an extra task and you need a suitable container that should be cleaned as well.
- › In case of using the re-filtering option, you have to maintain the recycling filter as well. This, in turn, is an additional task and involves handling a contaminated filter that may still contain other substances. This can even pose a health risk to the user.



Very easy to  
**operate and use:**

- › The innovative locking handle on the filter head ensures fast and convenient filter replacement without tools.
- › The integrated rinse button for releasing the pressure allows immediate pre-rinsing and venting.



**1.** To replace a consumed filter cartridge, open the locking handle.



**2.** Turn the locking handle as far as it will go, and actuate the flush valve and depressurize the system.



**3.** Remove the filter head from the depleted filter.

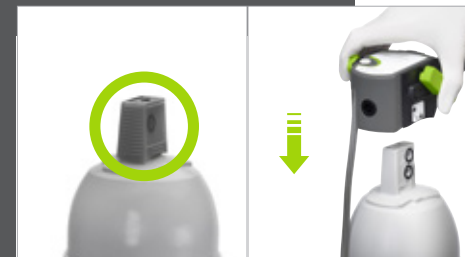

**4.** Remove the protective cap and place the filter head vertically onto the new cartridge.



**5.** Operate the flush valve and flush the filter system until the filtered water runs clear and without bubbles. Multidem is then ready to go again!

# All advantages at a glance



## Compatible

- › Suitable for use with conventional sterilizers
- › Flexible use in combination with the spray gun, which is suitable with all sterilizers and enables an easy rinsing of instruments
- › Possible connection of two sterilizers with a single Multidem



## Economical

- › No external power supply required
- › Optimized ion exchange resin

## User-friendly

- › Consumed filter cartridges can be replaced quickly and easily without additional tools
- › Cartridge can be positioned without a fixing/securing device



## Safe

- › The purified water complies with the relevant recommendations and regulations for the operation of steam sterilizers and for the treatment and preparation of instruments
- › Consistently high water quality, no lime scale deposits



# Technical data

<b>Type:</b>	<b>Multidem C27</b>	
<b>Operating pressure:</b>	2 bar–8.6 bar	
<b>Water temperature (inlet):</b>	4–30°C/40–86°F	
<b>Nominal flow rate:</b>	60 l/h	
<b>Water quality (out):</b>	demineralized (EN13060)	
<b>Water quality (in):</b>	drinking water	
<b>Weight:</b>	2.7 kg	
<b>Width/depth/height:</b>	124/123/476 mm	
<b>Operating position:</b>	vertical	
<b>Tube lengths:</b>	2 × 3 m	
<b>Safety valve:</b>		
<b>Backflow preventer:</b>	EB	
<b>Capacity tables:</b>	<b>Conductivity in intake water in µS/cm</b>	<b>Filter capacity in litres</b>
	50	2,250
	100	1,130
	200	565
	300	375
	400	280
500	225	
<b>Item supplied:</b>	filter head, cartridge, tubes and connections (incl. Water Block®), spray gun (optional)	

If devices are connected downstream of the device, make sure that appropriate steps are taken to prevent backflow in accordance with the guidelines, standards and regulations which are applicable in your country.

**W&H Sterilization Srl.**  
Via Bolgara, 2  
24060 Brusaporto (BG), **Italy**  
**t** +39 035-66 63 000  
**f** +39 035-50 96 988  
office.sterilization@wh.com  
**wh.com**

**W&H Dentalwerk Bürmoos GmbH**  
Ignaz-Glaser-Straße 53, Postfach 1  
5111 Bürmoos, **Austria**  
**t** +43 6274 6236-0  
**f** +43 6274 6236-55  
office@wh.com  
**wh.com**

Pictures are for illustrative purposes only. Additional equipment and accessories shown are not included as standard.

20516 AEN Rev. 001 / 14.06.2021  
Subject to alterations